

UCFS2 (Normal-duty)

Flange Units (Square)

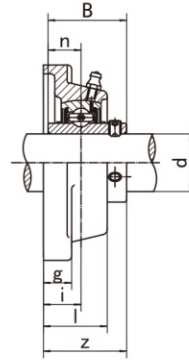
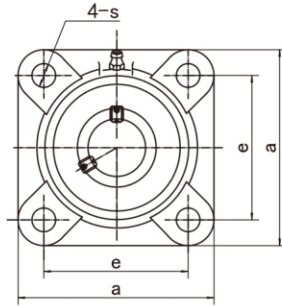

Unit NO.	Dimensions (mm / in.)										Bolt Size mm/in.	Bearing No.	Housing No.	Weight (kg)
	d	a	e	i	g	l	s	z	B	n				
UCFS204	20	86	63.5	20.6	9.5	33	11	38.9	31	12.7	M10	UC204	FS204	0.64
204-12	3/4	3-3/8	2-1/2	13/16	3/8	1-19/64	7/16	1-17/32	1.2205	0.500	3/8	UC204-12		0.64
UCFS205	25	95	70	21	11	35	11.5	40.8	34.1	14.3	M10	UC205	FS205	0.87
205-13	13/16	3-3/4	2-3/4	53/64	7/16	1-3/8	29/64	1-39/64	1.3425	0.563	3/8	UC205-13		0.91
205-14	7/8											UC205-14		0.90
205-15	15/16											UC205-15		0.88
205-16	1											UC205-16		0.87
UCFS206	30											108	82.5	22.6
206-17	1-1/16	4-1/4	3-1/4	57/64	33/64	1-29/64	33/64	1-49/64	1.5000	0.626	7/16	UC206-17	1.28	
206-18	1-1/8											UC206-18	1.29	
206-19	1-3/16											UC206-19	1.27	
206-20	1-1/4											UC206-20	1.26	
UCFS207	35											117	92	22
207-20	1-1/4	4-39/64	3-5/8	55/64	33/64	1-1/2	33/64	1-55/64	1.6890	0.689	7/16	UC207-20	1.60	
207-21	1-5/16											UC207-21	1.57	
207-22	1-3/8											UC207-22	1.54	
207-23	1-7/16											UC207-23	1.51	
UCFS208	40											130	101.5	24.5
208-24	1-1/2	5-1/8	4	31/32	5/8	1-39/64	35/64	2-5/32	1.9370	0.748	7/16	UC208-24	2.20	
208-25	1-9/16											UC208-25	2.17	
UCFS209	45											137	105	24.5
209-26	1-5/8	5-25/64	4-9/64	31/32	5/8	1-21/32	5/8	2-5/32	1.9370	0.748	9/16	UC209-26	2.46	
209-27	1-11/16											UC209-27	2.42	
209-28	1-3/4											UC209-28	2.38	
UCFS210	50											143	111	27.8
210-29	1-13/16	5-5/8	4-3/8	1-3/32	5/8	1-13/16	5/8	2-3/8	2.0315	0.748	9/16	UC210-29	2.77	
210-30	1-7/8											UC210-30	2.72	
210-31	1-15/16											UC210-31	2.67	
210-32	2											UC210-32	2.63	
UCFS211	55											162	130	31
211-32	2	6-3/8	5-1/8	1-7/32	11/16	1-31/32	43/64	2-17/32	2.1890	0.874	9/16	UC211-32	3.92	
211-33	2-1/16											UC211-33	3.86	
211-34	2-1/8											UC211-34	3.82	
211-35	2-3/16											UC211-35	3.75	
UCFS212	60											175	143	34
212-36	2-1/4	6-57/64	5-5/8	1-11/32	11/16	2-11/64	43/64	2-29/32	2.5630	1.000	9/16	UC212-36	4.97	
212-37	2-5/16											UC212-37	4.89	
212-38	2-3/8											UC212-38	4.82	
212-39	2-7/16											UC212-39	4.75	
UCFS213	65											184	149	38
213-40	2-1/2	7-1/4	5-55/64	1-1/2	55/64	2-9/32	45/64	3-1/16	2.5630	1.000	5/8	UC213-40	5.93	
213-41	2-9/16											UC213-41	5.84	
UCFS214	70											188	152	38
214-42	2-5/8	7-13/32	5-63/64	1-1/2	29/32	2-23/64	45/64	3-1/4	2.9370	1.189	5/8	UC214-42	6.59	
214-43	2-11/16											UC214-43	6.49	
214-44	2-3/4											UC214-44	6.39	
UCFS215	75											200	152.4	41
215-45	2-13/16	7-7/8	6	1-39/64	15/16	2-7/16	25/32	3-23/64	3.0630	1.311	23/32	UC215-45	7.42	
215-46	2-7/8											UC215-46	7.67	
215-47	2-15/16											UC215-47	7.56	
215-48	3											UC215-48	7.36	